



The Society of Rheology 86th Annual Meeting

Loews Philadelphia Hotel, Philadelphia, Pennsylvania

Meeting Schedule

Monday, October 6, 2014

	C-A	C-B	C-C	W-A	W-B	W-C
8:30			S. G. Hatzikiriakos (PL1) - <i>MH</i>			
9:20			Coffee Break			
10:00	SC1	BB1	SM1	CR1	BC1	SF1
10:25	SC2	BB2	SM2	CR2	BC2	SF2
10:50	SC3	BB3	SM3	CR3	BC3	SF3
11:15	SC4	BB4	SM4	CR4	BC4	SF4
11:40	SC5	BB5	SM5	CR5	BC5	SF5
12:05			Lunch Break			
1:30	SC6	BB6	SM6	CR6	FR1	SF6
1:55	SC7	BB7	SM7	CR7	FR2	SF7
2:20	SC8	BB8	SM8	CR8	FR3	SF8
2:45	SC9	BB9	SM9	CR9	FR4	SF9
3:10	SC10	BB10	SM10	CR10	FR5	SF10
3:35			Coffee Break			
4:00	SC11	BB11	SM11	CR11	FR6	SF11
4:25	SC12	BB12	SM12	CR12	FR7	SF12
4:50	SC13	BB13	SM13	CR13		SF13
5:15	SC14	BB14	SM14	CR14		SF14
5:40	SC15	BB15	SM15	CR15		SF15
6:05			End			

Tuesday, October 7, 2014

	C-A	C-B	C-C	W-A	W-B	W-C
8:30			N. J. Wagner (PL2) - <i>MH</i>			
9:20			Coffee Break			
10:00	SC16	BB16	SM16	NF1	BC6	CC1
10:25	SC17	BB17	SM17	NF2	BC7	CC2
10:50	SC18	BB18	SM18	NF3	BC8	CC3
11:15	SC19	BB19	SM19	NF4	BC9	CC4
11:40	SC20	BB20	SM20	NF5	BC10	CC5
12:05			Lunch Break / Society Business Meeting			
1:30	SC21	BB21	SM21	NF6	BC11	CC6
1:55	SC22	BB22	SM22	NF7	BC12	CC7
2:20	SC23	BB23	SM23	NF8	BC13	CC8
2:45	SC24	BB24	SM24	NF9	BC14	CC9
3:10	SC25	BB25	SM25	NF10	BC15	CC10
3:35			Coffee Break			
4:00	SC26	BB26	SM26	NF11	BC16	EF1
4:25	SC27	BB27	SM27	NF12	BC17	EF2
4:50	SC28	BB28	SM28	NF13	BC18	EF3
5:15	SC29	BB29	SM29	NF14	BC19	EF4
5:40	SC30	BB30	SM30	NF15	BC20	EF5
6:05			End			
7:00			Awards Reception			
8:00			Awards Banquet			

Wednesday, October 8, 2014

	C-A	C-B	C-C	W-A	W-B	W-C
8:30			S. J. Muller (PL3) - <i>MH</i>			
9:20			Coffee Break			
10:00	SC31	BB31	SM31	NF16	SF16	EF6
10:25	SC32	BB32	SM32	NF17	SF17	EF7
10:50	SC33	BB33	SM33	NF18	SF18	EF8
11:15	SC34	BB34	SM34	NF19	SF19	EF9
11:40	SC35	BB35	SM35	NF20	SF20	EF10
12:05			Lunch Break			
1:30	SC36	BB36	SM36	NF21	SG1	EF11
1:55	SC37	BB37	SM37	NF22	SG2	EF12
2:20	SC38	BB38	SM38	NF23	SG3	EF13
2:45	SC39	BB39	SM39	NF24	SG4	EF14
3:10	SC40	BB40	SM40	NF25	SG5	EF15
3:35			Coffee Break			
4:00	SC41	BB41	SM41	NF26	SG6	EF16
4:25	SC42	BB42	SM42	NF27	SG7	EF17
4:50	SC43	BB43	SM43	NF28	SG8	EF18
5:15	SC44	BB44	SM44	NF29	SG9	EF19
5:40	SC45	BB45	SM45	NF30	SG10	EF20
6:05			End			
6:05			Poster Session & Reception			

Thursday, October 9, 2014

	<i>MH</i>	C-B	C-C	C-D	C-A1	C-A2
8:00			R. H. Ewoldt (AP1) - <i>MH</i>			
8:40	SC46	BB46	SM46	SF21	SG11	EF21
9:05	SC47	BB47	SM47	SF22	SG12	EF22
9:30	SC48	BB48	SM48	SF23	SG13	EF23
9:55			Coffee Break			
10:25	SC49	BB49	SM49	SF24	SG14	EF24
10:50	SC50		SM50	SF25	SG15	EF25
11:15				SF26	SG16	EF26
11:40				SF27	SG17	EF27
12:05			End			

Session and Room Codes

AP = Award Presentations
 BB = Biomaterials and Biological Systems
 BC = Blends, Composites and Multiphase Systems
 CC = Confined and Coupled Systems
 CR = Computational Rheology
 EF = Emulsions, Foams and Interfacial Rheology
 FR = Food Rheology

NF = Non-Newtonian Fluid Mechanics and Stability
 PL = Plenary Lectures
 SC = Suspensions and Colloids
 SF = Self-assembly and Flow-induced Systems/Gels
 SG = Solids and Glasses
 SM = Polymer Solutions and Melts

C-A = Commonwealth A
 C-A1 = Commonwealth A1
 C-A2 = Commonwealth A2
 C-B = Commonwealth B
 C-C = Commonwealth C
 C-D = Commonwealth D
 MH = Millennium Hall
 W-A = Washington A
 W-B = Washington B
 W-C = Washington C

Monday, October 6

Morning

8:30	PL1. The wall slip of polymer melts: The rule or the exception? <u>S. G. Hatzikiriakos</u> Millennium Hall					
9:20	COFFEE BREAK					
	Commonwealth A	Commonwealth B	Commonwealth C	Washington A	Washington B	Washington C
	Suspensions and Colloids	Biomaterials and Biological Systems	Polymer Solutions and Melts	Computational Rheology	Blends, Composites & Multiphase	Self-assembly & Flow-induced Sys/Gels
10:00	SC1. The pressure of active matter. <u>J. F. Brady, S. Takatori and W. Yan</u>	BB1. Monitoring extracellular matrix (ECM) mechanics in 3D in vitro tumor models during fibrosis and invasion processes for rheology-informed cancer therapeutics. <u>D. P. Jones, W. Hanna, G. M. Cramer, H. El-Hamidi, L. Petrovic and J. P. Celli</u>	SM1. Viscoelastic properties of polymer electrolytes: Mechanical and light scattering studies of a model system. <u>Y. Wang, F. Fan, P. J. Griffin, A. Kisliuk and A. P. Sokolov</u>	CR1. Computationally efficient algorithms for incorporation of hydrodynamic and excluded volume interactions in Brownian dynamics simulations of high molecular weight polystyrene: An overview of the effective parameters in the coil-stretch transition. <u>A. Saadat and B. Khomami</u>	BC1. Rheological percolation in polymer nano-composites: Is there a universal scaling? <u>D. Rodrigue and H. Mahi</u>	SF1. Role of dynamical heterogeneity in the rheology of colloidal gels. <u>L. C. Hsiao, H. Kang, K. H. Ahn and M. J. Solomon</u>
10:25	SC2. Active microrheology of hydrodynamically interacting spheres: Normal stresses and osmotic pressure. <u>H. W. Chu and R. Zia</u>	BB2. Dynamic cell-material interactions measured by passive microrheology. <u>K. M. Schultz, K. A. Kyburz and K. S. Anseth</u>	SM2. Linear viscoelasticity and dielectric spectroscopy of ionomer/plasticizer mixtures: A transition from ionomer to polyelectrolyte. <u>Q. Chen, T. Tomic, N. Bao, J. H. Wang and R. H. Colby</u>	CR2. The effect of concentration, solvent quality and flow type on coil-stretch hysteresis in planar mixed flows of polymer solutions: A Brownian dynamics study. <u>C. Sasmal and J. R. Prakash</u>	BC2. Bulk and shear rheology of a silica/polystyrene nanocomposite: Reinforcement and dynamics. <u>R. Tao and S. L. Simon</u>	SF2. Assembly of rod-like particles in nematic liquid crystal films. <u>I. B. Liu, M. A. Gharbi, D. A. Beller, S. Yang, R. D. Kamien and K. J. Stebe</u>
10:50	SC3. Single particle motion in a sheared colloid dispersion. <u>A. S. Khair and T. Bechtel</u>	BB3. High frequency microrheology of hydrogels formed from peptide enantiomers. <u>E. M. Furst, P. J. Betramo, K. J. Nagy and J. P. Schneider</u>	SM3. Linear viscoelasticity of oligomeric sulfonated styrene near the sol-gel transition. <u>Q. Chen, C. Huang, R. H. Colby and R. A. Weiss</u>	CR3. Structure and rheology of polymer solutions from coarse-grained molecular dynamics simulations: Effects of polymer concentration, solvent quality and geometric confinement. <u>Y. Yang and R. Sureshkumar</u>	BC3. Application of double reptation and time-dependent relaxation theory to the linear viscoelasticity of polymer nanocomposites. <u>X. Chen and M. J. Sobjkovicz</u>	SF3. Non-templated fabrication of partially aligned BCC thin film colloidal crystals. <u>M. Joy, T. Muangnapoh, M. A. Snyder and J. F. Gilchrist</u>
11:15	SC4. Force-induced diffusion in hydrodynamically-interacting colloidal dispersions. <u>N. J. Hoh and R. Zia</u>	BB4. Hemofoam: A biopolymer-based foam for treating non-compressible hemorrhage. <u>S. R. Raghavan, M. B. Dowling and J. White</u>	SM4. Deconstructing double-network hydrogels: The importance of grafted chains for achieving toughness. <u>R. A. Weiss, S. Shams Es-haghi and A. I. Leonov</u>	CR4. Scaling relations for structural and rheological properties of chains of different architectures in dilute solutions: A molecular simulation study. <u>F. Khabaz and R. Khare</u>	BC4. Tethered nanoparticle-polymer composites: Phase behavior and rheology. <u>R. Mangal and L. A. Archer</u>	SF4. Viscoelastic focusing of rigid colloids in Poiseuille flow. <u>M. P. Howard, A. Nikoubashman, N. A. Mahynski and A. Z. Panagiotopoulos</u>
11:40	SC5. Passive microrheology thanks to multi-speckle diffusing wave spectroscopy. <u>J. Denis, G. Brambilla and G. Meunier</u>	BB5. Micro-heterogeneity metrics for diffusion in soft matter. <u>P. A. Vasquez, J. Mellnik, S. McKinley, J. Witten, D. Hill and G. Forest</u>	SM5. Carrageenan aggregation and gel transition. <u>F. Nettesheim, D. J. Londono, P. Badrinarayanan, C. J. Rasmussen, D. J. Walls, Y. Brun, L. E. Clinger, C. D. Chan and A. Golematis</u>	CR5. Structure and rheology of surfactant micelle and micelle-nanoparticle solutions from molecular dynamics simulations. <u>A. Sambasivam, S. Dhakal and R. Sureshkumar</u>	BC5. Conductive nanocomposites of polyethylene/oxidized polyethylene (PE/OPE) blends with thermally reduced graphene and carbon black. <u>M. Z. Iqbal, T. J. Arnold, S. P. Lonkar, A. A. Abdala and M. W. Liberatore</u>	SF5. Temperature dependent self-exfoliation of clay polymer nanocomposite. <u>H. H. Winter and B. Momani</u>
12:05	LUNCH BREAK					

Afternoon

	Commonwealth A	Commonwealth B	Commonwealth C	Washington A	Washington B	Washington C
	Suspensions and Colloids	Biomaterials and Biological Systems	Polymer Solutions and Melts	Computational Rheology	Food Rheology	Self-assembly & Flow-induced Sys/Gels
1:30	SC6. Taylor dispersion of a passive tracer in the pressure-driven flow of a concentrated suspension of rigid, non-colloidal spheres. <u>A. Ramachandran</u>	BB6. A multiaxial approach to shear rheology: opposite effects of axial loading on shear moduli of biopolymer networks and tissues. <u>A. S. van Oosten and P. A. Janmey</u>	SM6. The effect of kappa-carrageenan and salts on gelation behavior of concentrated solution of hydroxypropyl methylcellulose. <u>N. Almeida, L. Rakesh and J. Zhao</u>	CR6. Brownian dynamics of functionalized deformable nanocarriers. <u>A. Sarkar, D. M. Eckmann, P. S. Ayyaswamy and R. Radhakrishnan</u>	FR1. A critical gel fluid with high extensibility: The rheology of chewing gum. <u>A. M. Mannion, L. Martinetti, W. E. Voje, R. Xie, R. H. Ewoldt, L. D. Morgret, F. S. Bates and C. W. Macosko</u>	SF6. Peptide-based systems as equilibrium gels of valence-limited particles. <u>N. A. Dudukovic and C. F. Zukoski</u>

1:55	SC7. Hydrodynamic lift and flow-induced ordering of deformable particles under flow. <i>Y.-L. Chen, C.-T. Liao, Y.-F. Wu and S.-H. Wang</i>	BB7. Structure-function relations and rigidity percolation in bovine articular cartilage under shear. <i>J. L. Silverberg, A. R. Barrett, M. Das, P. B. Petersen, L. J. Bonassar and I. Cohen</i>	SM7. Self-healing and thermo responsive zwitterionic copolymers. <i>Y. Zhao, T. Bai, S. Jiang and A. Q. Shen</i>	CR7. Rheological model selection: Bayesian assessment of good fits versus credible models. <i>J. B. Freund and R. H. Ewoldt</i>	FR2. Gel point determination thanks to microrheology. <i>R. Ramsch and J. Denis</i>	SF7. Capillary-induced gelation in ternary blends of immiscible polymers and silica particles. <i>T. E. Domenech and S. S. Velankar</i>
2:20	SC8. Fall velocity of a dense ball in oscillatory cross-sheared concentrated suspensions. <i>F. Blanc, E. Lemaire and F. Peters</i>	BB8. In situ imaging of rapid articular cartilage deformation. <i>L. R. Bartell, L. J. Bonassar and I. Cohen</i>	SM8. A rheological study on the role of molecular structure on interfacial self-adhesion of polyethylene films at elevated temperatures. <i>Z. Najarzadeh and A. Ajji</i>	CR8. Non-equilibrium fluctuations in "jammed" associative polymer networks under stress. <i>A. R. Baljon, A. Kruisheer and M. Wilson</i>	FR3. Microrheology of yoghurt formation. <i>J. Denis, R. Ramsch and G. Brambilla</i>	SF8. A green solar paint from precrystallized components. <i>N. A. Nguven, R. Remy and M. E. Mackay</i>
2:45	SC9. Disturbance flows produced by polymeric micelles in simple-shear fields. <i>B. A. Rolfe and Y. L. Joo</i>	BB9. Unraveling the nonlinear viscoelastic properties of fibrin using LAOS. <i>G. W. Peters, T. H. van Kempen and F. N. van de Vosse</i>	SM9. The effect of isomer type on the thermal and rheological properties of poly-(ether-imides). <i>M. Chellamuthu and D. Doraiswamy</i>	CR9. Structural change and oscillating dynamics of colloidal gels under oscillatory shear flow. <i>J. D. Park and K. H. Ahn</i>	FR4. Advanced rheometric tools for food applications. <i>J. Laeuger</i>	SF9. Mechanisms of shear thickening in transient guar networks. <i>Y. T. Hu</i>
3:10	SC10. Flow-induced microstructure and rheology of linear and branched wormlike micelles using rheo-SANS and 1-2 plane flow-SANS. <i>J. P. Rich, M. R. Weaver, K. M. Weigandt and G. S. Smith</i>	BB10. Interplay of platelets, fibrinogen, and erythrocytes on the viscoelastic properties of contracting clots. <i>V. Tutwiler, R. Litvinov, C. Nagaswami, T. Lebedeva, D. Cines and J. Weisel</i>	SM10. Mobility of nanoparticles in semi-dilute polymer solutions. <i>F. Babaye Khorasani, R. Poling-Skutvik, R. Krishnamoorti and J. C. Conrad</i>	CR10. Application of non-uniform magnetic fields on ferrofluid colloidal dispersions using an iterative constraint method: A Brownian dynamics study. <i>L. E. Wedgwood and S. H. Dubina</i>	FR5. Revealing the role of starch in a hydrating snack food bolus: Combining α -amylase mediated starch digestion with transient rheology. <i>M. W. Boehm, J. R. Stokes, F. J. Warren, M. E. Jackson, S. K. Baier and M. J. Gidley</i>	SF10. Water sensitive self-assembly of gelators in oil: A bioinspired strategy for sealing oil leaks from submerged tubes. <i>H. Oh, N. A. Yaraghi and S. R. Raghavan</i>
3:35			COFFEE BREAK			
4:00	SC11. Orthogonal superposition rheology as a tool to study structural changes in ER fluids. <i>C. A. Gracia-Fernández, E. Aadil, F. Aly and R. Bharath</i>	BB11. Silk e-gel viscoelasticity. <i>A. P. Tabatabai, D. L. Blair and D. L. Kaplan</i>	SM11. Understanding the relations between free volume and the temperature and pressure coefficients of viscosity for miscible polymer blends. <i>R. Cardinaels, L. Polito, J. Pionteck and P. Moldenaers</i>	CR11. Electrorheology of vesicle suspensions. <i>S. Veerapaneni</i>	FR6. Extensional flow to formulate micron-scale oil-in-water emulsions. <i>D. Song, J. Casasnovas, S. Agarwal, R. Gupta and M. Padmanabhan</i>	SF11. Computational studies of flow-induced structural changes in self-associating polymer networks. <i>M. Wilson and A. R. Baljon</i>
4:25	SC12. Orthogonal superposition rheometry of colloidal glasses. <i>A. R. Jacob, A. S. Poulos, S. Kim, J. Vermant and G. Petekidis</i>	BB12. Correlation between viscoelastic properties of cystic fibrosis mucus and patient clinical status. <i>G. Tomaiuolo, G. Rusciano, S. Caserta, A. Carciati, V. Carnovale, P. Abete, A. Sasso and S. Guido</i>	SM12. Dielectric relaxation of entangled monodisperse polyisoprene: Contribution of constraint release. <i>H. Watanabe and Y. Matsumiya</i>	CR12. Direct numerical simulations (DNS) of particles in spatially varying electric fields. <i>E. C. Amah, P. Singh and M. Janjua</i>	FR7. Steady state rheology of HPMC solutions with a polyol plasticizer. <i>C. A. Pinzon and A. Acevedo</i>	SF12. Mesoscopic modeling and simulation of transiently networked fluids/gels. <i>L. Zhou and L. P. Cook</i>
4:50	SC13. Mechanical anisotropy in colloidal gels: Superposition rheology and 2D-SAOS. <i>S. Kim, J. Mewis, C. Clasen and J. Vermant</i>	BB13. The gelation of oil using ethylcellulose. <i>A. G. Marangoni and M. Davidovich-Pinhas</i>	SM13. Component relaxation times in entangled binary blends of linear chains: Reptation/CLF along partially or fully dilated tube. <i>Y. Matsumiya, H. Watanabe and E. van Ruymbeke</i>	CR13. Numerical simulation of forced droplet formation with complex fluids. <i>G. E. Mårtensson, A. Mark, M. Svensson and D. Grafström</i>	FR8. Steady state rheology of HPMC solutions with a polyol plasticizer. <i>C. A. Pinzon and A. Acevedo</i>	SF13. Spatial mapping of flow-induced molecular alignment in a non-crystalline biopolymer fluid using double quantum filtered (DQF) ²³ Na MRI. <i>G. E. Pavlovskaya and T. Meersmann</i>
5:15	SC14. Rayleigh-Plateau instability of magnetorheological suspensions in toggled fields. <i>J. L. Bauer, J. W. Swan and E. M. Furst</i>	BB14. Composite biopolymer hydrogels with a thermally-activated component. <i>J. C. White and S. R. Bhatia</i>	SM14. Constitutive equations, and maximum stretch, for entangled combs and randomly branched polymers. <i>D. J. Read, C. Das, H. Lentzakis and D. Vlassopoulos</i>	CR14. Flows in irregular geometries simulated by Dissipative Particle Dynamics have improved convergence when guided by tailored body forces. <i>B. Caswell, M. Deng, A. Yazdani and G. E. Karniadakis</i>	FR9. Steady state rheology of HPMC solutions with a polyol plasticizer. <i>C. A. Pinzon and A. Acevedo</i>	SF14. A Janus particle viscometer. <i>I. Kretzschmar</i>
5:40	SC15. Understanding yield stress enhancement in magnetorheological suspensions with nonmagnetizable particles. <i>B. T. Wilson and D. J. Klingenberg</i>	BB15. Hybrid crosslink single polymer network hydrogels for tissue engineering and substance delivery. <i>J. Jancar, J. Zidek, L. Vojtova and I. Chamradova</i>	SM15. Comparison of the single molecular dynamics of linear and circular DNAs in microfluidic planar extensional flows. <i>Y. Li, C. A. Brockman, D. Y. Yates, K.-W. Hsiao, G. B. McKenna, C. M. Schroeder, M. J. San Francisco, J. A. Kornfield and R. M. Anderson</i>	CR15. 3D finite element formulation for flows with nonlinear partial slip condition on curved geometries. <i>S. Onkar, L. Fovargue, J. Abbott and S. Vaddiraju</i>	FR10. Steady state rheology of HPMC solutions with a polyol plasticizer. <i>C. A. Pinzon and A. Acevedo</i>	SF15. Microstructural origins of yield, strain hardening and hysteresis in thermoplastic elastomers under uniaxial deformation: An in-situ tensile-SANS study. <i>C. R. López-Barrón and A. P. Eberle</i>
6:05				END		

Tuesday, October 7

Morning

8:30	PL2. Rheology revealed - Measuring the atomistic-to-micron scale structure and dynamics of complex fluids and soft matter under flow with neutrons. <i>N. J. Wagner</i> (Bingham Lecture)					Millennium Hall
9:20	COFFEE BREAK					
	Commonwealth A	Commonwealth B	Commonwealth C	Washington A	Washington B	Washington C
	Suspensions and Colloids	Biomaterials and Biological Systems	Polymer Solutions and Melts	Non-Newtonian Fluid Mech & Stability	Blends, Composites & Multiphase	Confined and Coupled Systems
10:00	SC16. Rheology of non-Brownian particles suspended in a colloidal shear thickening fluid. <i>C. D. Cwalina and N. J. Wagner</i>	BB16. Interfacial rheological properties of vibrio cholerae biofilms. <i>E. C. Hollenbeck, J. Y. Lim, J. Fong, F. H. Yildiz, L. Cegelski and G. G. Fuller</i>	SM16. Dynamics of non-concatenated entangled cyclic polymers. <i>M. Rubinstein and S. V. Panyukov</i>	NF1. Jetting and jet break-up of complex fluids in inkjet printing. <i>O. G. Harlen, N. F. Morrison and C. McIlroy</i>	BC6. Advances in characterization of rheology at high strain rates related to paint atomization. <i>E. C. Houze, M. R. Koerner, J. R. Moore, G. H. McKinley and B. Keshavarz</i>	CC1. Probing colloidal flocculation during solvent removal in microscale droplet reactors. <i>S. M. Vuong, B. M. Bleier, S. L. Anna and L. M. Walker</i>
10:25	SC17. FT-rheology and MITLAOS analyses of concentrated fumed silica dispersions. <i>G. A. Holmes, J. E. Seppala, M. Chellamuthu and K. D. Rice</i>	BB17. Rheological properties of <i>Pseudomonas aeruginosa</i> biofilm formation in the presence of quorum sensing inhibitors. <i>U. Daalkhajav and T. W. Walker</i>	SM17. Rheological study of crystallization behavior of PLA and PLA-reinforced flax fiber biocomposites. <i>A. M. Arias, M.-C. Heuzey and P. M. Wood-Adams</i>	NF2. Fiber spinning under filament pull-out conditions: A stability analysis. <i>P. Anderson, C. Walt, van der, M. Hulsen and A. Bogaerds</i>	BC7. Ion transport in porous battery electrodes. <i>A. M. Grillet, S. A. Roberts, D. E. Wesolowski, C. C. Roberts, A. N. Allen, L. A. Mondy, R. P. Grant, B. McKenzie, B. Shelden, M. J. Martinez and J. Clausen</i>	CC2. Probing aerosol particle interfaces with biphasic microfluidics. <i>C. S. Dutcher and A. R. Metcalf</i>
10:50	SC18. Large amplitude oscillatory shear rheology study of shear-thickening dispersions. <i>S. Khandavalli and J. Rothstein</i>	BB18. Rheology of extracellular matrices of swarming colonies of <i>Pseudomonas aeruginosa</i> . <i>R. De Dier, W. Sempels, J. Hofkens and J. Vermant</i>	SM18. Flow-induced crystallization of polyethylene as probed by Raman spectroscopy. <i>K. B. Migler, A. Hight Walker and A. P. Kotula</i>	NF3. Modeling the polymer wet spinning process. <i>H. Zerbe and A. J. McHugh</i>	BC8. Dissipative particle dynamics studies on the controlled assembly of polymer grafted nanorods. <i>S. Khani, J. Maia and S. Rowan</i>	CC3. Rheological behavior of unfilled and filled, uncrosslinked and ionically crosslinked guar solutions. <i>A. C. Barbati, A. Robisson and G. H. McKinley</i>
11:15	SC19. Particle-scale simulation of shear thickening in dense colloidal suspensions. <i>R. Seto, R. Mari, J. F. Morris and M. M. Denn</i>	BB19. Interfacial rheology's role on the measurement of the bulk rheology of biological solutions. <i>Z. Zhang, S. Barman and G. F. Christopher</i>	SM19. SAXS/WAXS studies on the temperature and flow rate dependence of uniaxial extensional flow-induced crystallization of poly(1-butene). <i>E. M. McCready and W. Burghardt</i>	NF4. A regularized thin-fiber model for nanofiber formation by centrifugal spinning. <i>S. M. Taghavi and R. G. Larson</i>	BC9. Magnetic microdisks in a rotating magnetic field. <i>H. Song, T. W. Walker, A. Jander and P. Dhagat</i>	CC4. Validation via rheological experiments of theories for the flow through porous media. <i>M. Minale, C. Carotenuto, A. Vananroye and J. Vermant</i>
11:40	SC20. Modified DPD method for simulation of colloidal suspensions. <i>S. Jamali, A. Boromand and J. Maia</i>	BB20. Rheology of bacterial adhesion layers at air/water and oil/water interfaces. <i>P. A. Rühls, L. Böni, L. Böcker, F. Inglis, C. Jans, T. de Wouter and P. Fischer</i>	SM20. The influence of concentration on extensional rheology of polymer solutions. <i>O. Huang, L. Hengeller, N. J. Alvarez and O. Hassager</i>	NF5. Fabrication of polymer nanofibers using centrifugal jet spinning. <i>L. Ren, R. Ozisik, S. P. Kotha and P. T. Underhill</i>	BC10. A preliminary investigation into fiber length effects on the transient rheology of long glass fiber suspensions. <i>M. J. Cieslinski, G. M. Lambert and D. G. Baird</i>	CC5. Viscoelastic focusing down to the nanoscale. <i>I. De Santo, G. D'Avino, F. Greco, P. A. Netti and P. L. Maffettone</i>
12:05	LUNCH BREAK / SOCIETY BUSINESS MEETING Commonwealth D					

Afternoon

	Commonwealth A	Commonwealth B	Commonwealth C	Washington A	Washington B	Washington C
	Suspensions and Colloids	Biomaterials and Biological Systems	Polymer Solutions and Melts	Non-Newtonian Fluid Mech & Stability	Blends, Composites & Multiphase	Confined and Coupled Systems
1:30	SC21. Rheology and morphology of lyotropic nanocylinder dispersions. <i>V. A. Davis</i>	BB21. Using a live cell monolayer rheometer to probe the mechanics of the cytoskeleton. <i>C. M. Elkins, W.-J. Shen, V. K. Khor, F. B. Kraemer and G. G. Fuller</i>	SM21. The influence of hydrogen bonding on nonlinear extensional rheology of supramolecular poly(n-butyl acrylate). <i>A. Shabbir, S. Goldansaz, N. J. Alvarez, E. V. Ruyembeke and O. Hassager</i>	NF6. Analysis of steady and transient shear banding in the flow of polymer solutions. <i>M. Cromer, G. H. Fredrickson and G. Leal</i>	BC11. High pressure- and temperature-dependent viscous anomalies in polymer oil mixtures. <i>P. Shiller, B. LotfizadehDehkordi and G. L. Doll</i>	CC6. Direct visualization of near-wall structure of sheared monosized suspensions. <i>J. F. Gilchrist and T. Perera</i>
1:55	SC22. The concentration instability of a sedimenting suspension of weakly flexible fibers. <i>H. Manikantan, L. Li, S. E. Spagnolie and D. Saintillan</i>	BB22. In vitro live-cell imaging to determine how spatial gradients in shear stress affect migratory response of endothelial cells. <i>V. N. Surya, M. A. Ostrowski, E. Huang, A. R. Dunn and G. G. Fuller</i>	SM22. Slip of polydisperse polymers: Molecular weight distribution above and below the plane of slip. <i>S. M. Sabzevari, S. Strandman and P. M. Wood-Adams</i>	NF7. Hi-Fidelity simulation of flow-induced inhomogeneous disentanglement and shear banding in polymeric melts. <i>M. Mohagheghi and B. Khomami</i>	BC12. Effect of thermal history on the behavior of thixotropic elasto-visco-plastic materials. <i>M. Geri, G. H. McKinley, R. Venkatesan and K. Sambath</i>	CC7. Flow of particulate suspensions in the 4:1 microcontraction channel: A simulation study. <i>K. H. Ahn</i>

2:20	SC23. Rheo-optical response of carbon nanotube suspensions. <i>G. Natale, N. K. Reddy, G. Ausias, J. Ferec, M.-C. Heuzey and P. J. Carreau</i>	BB23. High resolution mapping of intracellular fluctuations using carbon nanotubes. <i>N. Fakhri, A. Wessel, C. Willms, D. Klopfenstein, M. Pasquali, F. MacKintosh and C. F. Schmidt</i>	SM23. Molecular scale simulations of rheological behavior – Understanding slip of molten polymers. <i>J. R. Dorgan and N. A. Rorrer</i>	NF8. Intriguing nonlinear instability phenomena occurring in film blowing process. <i>J. S. Lee, H. W. Jung and J. C. Hyun</i>	BC13. The effect of pH and salinity on the rheology of concentrated aqueous suspensions of sphalerite/silica mixtures. <i>D. Yang, Q. Liu, H. Zeng and L. Xie</i>	CC8. Flow-induced segregation in confined suspensions: Effect of particle shape and rigidity. <i>K. K. Sinha and M. D. Graham</i>
2:45	SC24. On the negative magneto-rheological effect of a rod-like hematite particle suspension by means of Brownian dynamics simulations. <i>A. Satoh</i>	BB24. Rheology of concentrated algae suspensions. <i>V. Breedveld, V. Prasad and S. Edgar</i>	SM24. Shear banding in entangled polymers in micron scale gap: A confocal-rheoscopic study. <i>P. Boukamy and S.-Q. Wang</i>	NF9. Nonlinear elastic instability in channel flows at low Reynolds numbers. <i>P. E. Arratia, A. Morozov and C. Wagner</i>	BC14. Melt rheology of polypropylene-clay nanocomposites with silane coupling agents. <i>W. Ren and K. Jayaraman</i>	CC9. Mechanism of wall-induced drift of a single particle in viscoelastic confined flows. <i>R. G. Henriquez and M. D. Graham</i>
3:10	SC25. Using rheology to characterize graphene oxide. <i>I. M. Ismail, A. A. Abdala and C. W. Macosko</i>	BB25. Rheological properties of fire ant aggregations. <i>M. Tennenbaum, Z. Liu, A. Fernandez-Nieves and D. L. Hu</i>	SM25. Chain conformation, entanglements, and the origin of stress overshoot during startup shear of entangled polymer melts. <i>Y. Lu, L. An, S.-Q. Wang and Z.-G. Wang</i>	NF10. Elastic instabilities in the flow of complex fluids. <i>L. Casanellas, S. Lerouge and A. Lindner</i>	BC15. Rheological characterization of highly filled composite systems for injection molding applications. <i>K. A. Koppi</i>	CC10. Dynamical role of slip heterogeneities in confined flows. <i>A.-L. Vayssade, F. Monti, M. Cloitre and P. Tabeling</i>
3:35	COFFEE BREAK					
4:00	SC26. Patterning surfaces with colloid-bottlebrush polymer suspensions. <i>C. Pellet, J.-M. Suau and M. Cloitre</i>	BB26. Characterization of aqueous alginate solutions at high concentrations with neutron scattering and rheology. <i>H. B. Eral, K. Bavand, G. H. McKinley and P. S. Doyle</i>	SM26. Finite cohesion due to chain entanglement in polymer melts. <i>S. Cheng, Y. Lu, L. An, Z.-G. Wang and S.-Q. Wang</i>	NF11. Using yield stress fluids for shaped multi-layer flow configurations. <i>I. Frigaard, S. Hormozi and G. Dunbrack</i>	BC16. Cocontinuous blends of immiscible polymers: Modeling stability and cocontinuity range. <i>A. T. Hedegaard and C. W. Macosko</i>	EF1. Understanding the physics of nanoemulsion formation. <i>A. Gupta, H. B. Eral, T. A. Hatton and P. S. Doyle</i>
4:25	SC27. Oscillatory rheology of colloidal near hard-sphere suspensions with ASD. <i>S. Marene and J. F. Morris</i>	BB27. Viscosity and short time dynamics of concentrated solutions of proteins interacting with a short range attractive and long range repulsive interaction. <i>P. D. Godfrin, K. Hong, L. Porcar, P. Falus, N. J. Wagner and Y. Liu</i>	SM27. Strain hardening in startup shear. <i>G. Liu, M. Wang and S.-Q. Wang</i>	NF12. Macro-scale drop encapsulation in yield stress fluids. <i>S. Hormozi, A. Maleki Zamenjani, A. Rostai and I. Frigaard</i>	BC17. Morphological stability of PLA/PBAT and PLA/PBSA blends under shear flow. <i>M. Nofar, A. Maani, M.-C. Heuzey and P. J. Carreau</i>	EF2. Morphology evolution of mesoporous bicontinuous emulsions. <i>A. Perazzo, V. Preziosi and S. Guido</i>
4:50	SC28. The Medium Amplitude Oscillatory Shear (MAOS) of semi-dilute colloid dispersions - Third harmonic of the suspension stress. <i>J. W. Swan, K. Gurnon and N. J. Wagner</i>	BB28. Rheology and thermodynamics/scattering of concentrated protein solutions: pH-dependent viscoelasticity of solutions of bovine serum albumin and monoclonal antibodies. <i>P. Sarangapani, S. D. Hudson, A. Parupudi, P. Manikvar, J. Weaver, R. Jones, K. B. Migler and J. A. Pathak</i>	SM28. The behavior of strongly entangled polymers in strong shearing startup flows. <i>P. D. Olmsted, R. S. Graham and E. P. Henry</i>	NF13. Yield stress fluid droplet impact on coated surfaces. <i>B. C. Blackwell, M. E. Deetjen and R. H. Ewoldt</i>	BC18. Mechanical responses of a nano-sandwich of thin polymer layer/single layer graphene/thin polymer layer. <i>X. Li and G. B. McKenna</i>	EF3. Flow induced localized jamming in sheared dense emulsions. <i>S. K. Dutta and D. L. Blair</i>
5:15	SC29. Modeling thixotropic colloidal dispersions in Large Amplitude Oscillatory Shear (LAOS) experiments. <i>M. J. Armstrong, A. N. Beris and N. J. Wagner</i>	BB29. High temperature rheometry of lignocellulosic biomass. <i>D. J. Klingenberg, T. W. Root, C. T. Scott, C. Houtman, K. J. Bourne and V. Subramaniam</i>	SM29. Microscopic theory of tube constraints and elasticity in isotropic, anisotropic, confined and deformed entangled polymer liquids. <i>K. Schweizer, D. Sussman, W.-S. Tung, K. Winey and R. Riggleman</i>	NF14. Viscoplastic dip-coating. <i>M. Maillard, A.-L. Andrieu, J. Bleyer, J. Bouglé and P. Coussot</i>	BC19. The interplay between hydrodynamic and frictional forces in a shear-thickened suspension. <i>N. Lin, M. Hermes, B. Guy, W. Poon, Y. Su, R. Zia and I. Cohen</i>	EF4. Universal scaling characteristics of stress relaxation in jammed emulsions. <i>P. Boukamy, S. Vasudevan and B. Tighe</i>
5:40	SC30. Study of nonlinear behavior in oscillatory shear of dense colloidal suspensions using asymptotically nonlinear material functions. <i>M. Agarwal, R. H. Ewoldt and C. F. Zukoski</i>	BB30. Pressure-driven flow of lignocellulosic biomass: A compressible Bingham fluid. <i>J. C. Duncan, A. Shahravan, M. D. Graham, D. J. Klingenberg, C. T. Scott, K. J. Bourne and R. Fleisner</i>	SM30. Almost ab initio multi-level slip-link modeling. <i>M. Andreev and J. D. Schieber</i>	NF15. Flow of elasto-viscoplastic materials past a flat plate. <i>M. R. Ferreira, S. L. Frey, M. F. Naccache and P. R. de Souza Mendes</i>	BC20. Interfacial processes at the polymer/polymer interface probed by linear viscoelasticity coupled with FTIR measurements. <i>J. Nasrollah Gavgani, A. Faramarzi Jolfaei, F. Goharpey, S. S. Velankar and R. Foudazi</i>	EF5. Modified dissipative particle dynamics: Common Trends in soft suspensions from emulsions to vesicles. <i>A. Boromand, S. Jamali and J. Maia</i>
6:05	END					
7:00	AWARDS RECEPTION Millennium Prefunction Area					
8:00	AWARDS BANQUET Millennium Hall					

Wednesday, October 8

Morning

8:30	PL3. Microfluidic tools for the manipulation and analysis of macromolecules, vesicles, capsules, and suspensions. <i>S. J. Muller</i> Millennium Hall					
9:20	COFFEE BREAK					
	<i>Commonwealth A</i>	<i>Commonwealth B</i>	<i>Commonwealth C</i>	<i>Washington A</i>	<i>Washington B</i>	<i>Washington C</i>
	Suspensions and Colloids	Biomaterials and Biological Systems	Polymer Solutions and Melts	Non-Newtonian Fluid Mech & Stability	Self-assembly & Flow-induced Sys/Gels	Emulsions, Foams & Interfacial
10:00	SC31. Correlation of dynamic viscosity, normal stresses and diffusivity of colloidal glasses with excess entropy. <i>K. Khalil, L. Mohan, M. Cloitre and R. T. Bonnecaze</i>	BB31. Shape transitions of vesicles in extensional flows: Dumbbells, pearling, and buckling. <i>V. Narsimhan, A. P. Spann and E. Shaqfeh</i>	SM31. Simple desktop calculations for slip-link predictions of entangled polymers. <i>M. Katzarova, L. Yang, M. Andreev and J. D. Schieber</i>	NF16. Laminar-turbulent boundary and its implication for friction drag reduction in Newtonian and viscoelastic turbulent flows. <i>L. Xi and M. D. Graham</i>	SF16. Rheological characterization of fracture-healing behavior displayed by a physically associating polymer gel subjected to shear deformation. <i>K. A. Erk and T. Thornell</i>	EF6. Drainage and stratification kinetics of foam films. <i>Y. Zhang, S. Yilixiati and V. Sharma</i>
10:25	SC32. Stress relaxation and aging in colloidal glasses. <i>L. Mohan, R. T. Bonnecaze and M. Cloitre</i>	BB32. Manipulating and separating polymers and particles at the microscale using conformation-dependent electrophoretic mobility. <i>H. Pandey and P. T. Underhill</i>	SM32. Molecular scale simulations of rheological behavior – Importance of polydispersity. <i>N. A. Rorrer and J. R. Dorgan</i>	NF17. The dynamics of burst and hibernation in Newtonian and viscoelastic turbulence. <i>S.-N. Wang and M. D. Graham</i>	SF17. Thin films of homopolymers and cylinder-forming diblock copolymers under shear. <i>A. Nikoubashman, R. L. Davis, B. T. Michal, P. M. Chaikin, R. A. Register and A. Z. Panagiotopoulos</i>	EF7. The mechanics of low-density open-cell foams: Linear elasticity and quasi-static crushing. <i>A. M. Kraynik, S. Gaitanaros and S. Kyriakides</i>
10:50	SC33. Probing particle-level stress fluctuations in a colloidal suspension. <i>N. Lin, M. Bierbaum, S. P. James and I. Cohen</i>	BB33. The rheology of nanoparticles in blood for improved cancer therapy. <i>E. Carboni, Y. Guo, G. Bouchillon, A. Kadilak, L. Shor and A. K. Ma</i>	SM33. Dynamics of individual molecules in entangled polymeric melts under homogenous shear flow: An atomistic simulation study. <i>M. H. Nafar Sefiddashi, B. J. Edwards and B. Khomami</i>	NF18. Role of geometry on large mach number instabilities around confined cylinders. <i>X. Shi and G. F. Christopher</i>	SF18. Interaction of nonionic block copolymer with poly(acrylic acid) and poly(ethylene oxide) in aqueous medium. <i>A. M. Pragatheeswaran and S. B. Chen</i>	EF8. Multiscale phenomena in liquid foam fracture. <i>S. Hilgenfeldt, P. S. Stewart and S. H. Davis</i>
11:15	SC34. Trapped dynamics and pair interactions of concentrated nanoparticle suspensions. <i>Y. H. Wen and L. A. Archer</i>	BB34. A multiscale Adhesive Dynamics model to study the interaction of nonspherical neutrophils with the endothelium. <i>A. D. Rocheleau, R. Sumagin and M. R. King</i>	SM34. Simulation of dilute solutions of flexible polyelectrolyte chains: Equilibrium properties and force-extension behaviour. <i>M. Malekzadeh Moghani and B. Khomami</i>	NF19. Models for viscoelastic fluids and their effects on flow instabilities. <i>Y. Guo and J. L. Bassani</i>	SF19. Structural dynamics of surfactant solutions in planar extensional flow. <i>B. Luo and W. Burghardt</i>	EF9. Probing foam stability in porous media with micromodels. <i>S. L. Biswal</i>
11:40	SC35. Jamming and yielding of binary colloidal glasses. <i>A. Agrawal and L. A. Archer</i>	BB35. Impact of blood rheology and hemodynamics on the adhesive landscape of functionalized nanocarriers to the blood vessel wall. <i>H.-Y. Yu, H. Vitoshkin, D. M. Eckmann, P. S. Ayyaswamy and R. Radhakrishnan</i>	SM35. Hi-fidelity Brownian dynamics simulation of non-equilibrium properties of macromolecules in good solvents: A bottom-up approach. <i>M. Malekzadeh Moghani and B. Khomami</i>	NF20. Transient response of a soft glassy fluid in porous medium. <i>A. Sarkar and D. L. Koch</i>	SF20. Study of diffusion effects in shear banding micellar solutions. <i>N. Germann, A. N. Beris and L. P. Cook</i>	EF10. Impact of rheological properties on the foaming behavior of linear and branched polylactide. <i>N. Najafi, M.-C. Heuzey, P. J. Carreau, D. Therriault and C. B. Park</i>
12:05	LUNCH BREAK					

Afternoon

	<i>Commonwealth A</i>	<i>Commonwealth B</i>	<i>Commonwealth C</i>	<i>Washington A</i>	<i>Washington B</i>	<i>Washington C</i>
	Suspensions and Colloids	Biomaterials and Biological Systems	Polymer Solutions and Melts	Non-Newtonian Fluid Mech & Stability	Solids and Glasses	Emulsions, Foams & Interfacial
1:30	SC36. Metastability and arrested phase separation in asymmetric mixtures of soft and hard colloids. <i>D. Truzzolillo, J. Marakis and D. Vlassopoulos</i>	BB36. Microrheology of therapeutic protein solutions. <i>L. L. Josephson, W. J. Galush and E. M. Furst</i>	SM36. The general low-frequency prediction for asymptotically-nonlinear material functions in oscillatory shear. <i>N. A. Bharadwaj and R. H. Ewoldt</i>	NF21. Flow of thixotropic elasto-viscoplastic materials through a planar 1:4 sudden expansion. <i>F. Link, S. L. Frey, M. F. Naccache and P. R. de Souza Mendes</i>	SG1. Experiments needed for critical evaluation of constitutive models for glassy polymers. <i>J. Caruthers and G. Medvedev</i>	EF11. Scaling analysis and mathematical theory of the interfacial stress rheometer. <i>S. Fitzgibbon and E. Shaqfeh</i>
1:55	SC37. Rheology of a bimodal suspension containing rigid and soft particles. <i>N. C. Shapley, O. Isijola and A. Chaturvedi</i>	BB37. A microfluidic imaging method to study red blood cell membrane viscoelasticity. <i>G. Tomaiuolo, L. Lanotte, A. Cassinese and S. Guido</i>	SM37. The QL-LAOS methodology applied to viscoelastic liquids. <i>A. A. Alicke, M. E. Pfeiffer and P. R. de Souza Mendes</i>	NF22. "Breakage" of non-Newtonian character in flows through porous medium: Evidence from NMR data and numerical simulations. <i>T. Chevalier, S. Rodts, J. Bleyer, X. Chateau and P. Coussot</i>	SG2. Yielding, failure and strain hardening in uniaxial compression of polymer glasses. <i>P. Lin, J. Liu and S.-Q. Wang</i>	EF12. Influence of interfacial rheology on the dynamics of the tear film. <i>M. S. Bhamla and G. G. Fuller</i>

2:20	SC38. Effect of particle size dispersity on the rheology of depletion mixtures of polymers and bidispersed colloids. <i>R. Pandey and J. C. Conrad</i>	BB38. Novel stochastic method using constraints for modeling of blood rheology. <i>K. H. Kim and L. E. Wedgewood</i>	SM38. Normal stress differences in large-amplitude oscillatory shear flow for dilute rigid dumbbell suspensions. <i>A. M. Schmalzer, R. B. Bird and A. J. Giacomin</i>	NF23. Flow of a yield stress fluid in a self-affine fracture. <i>T. Chevalier and L. Talon</i>	SG3. The age of polymer glasses: What is the effect of stress? <i>T. Engels and L. Govaert</i>	EF13. Elasticity of microscale volumes of viscoelastic soft matter by cavitation rheometry. <i>L. Pavlovsky, M. Ganesan, J. G. Younger and M. J. Solomon</i>
2:45	SC39. Doping colloidal spheres with dimers: An additional handle on suspension rheology. <i>B. D. Leahy and I. Cohen</i>	BB39. Modeling of human blood rheology in transient shear flows. <i>A. J. Apostolidis, M. J. Armstrong and A. N. Beris</i>	SM39. Quantifying the linear and non-linear rheology of sprayable complex liquids. <i>B. Keshavarz, G. H. McKinley, E. C. Houze, J. R. Moore and M. R. Koerner</i>	NF24. Displacement of yield stress fluid in horizontal pipe. <i>G. L. Moises, I. Frigaard and M. F. Naccache</i>	SG4. Identifying structural flow defects in amorphous solids. <i>S. S. Schoenholz, E. D. Cubuk, J. Rieser, B. D. Malone, D. J. Durian, E. Kaxiras and A. J. Liu</i>	EF14. Targeted synthesis of core/shell microcapsules using interfacial rheology, shell micromechanics and morphology analysis. <i>P. Ermi</i>
3:10	SC40. Dynamics of cubic colloids. <i>J. R. Royer, G. L. Burton, D. L. Blair and S. D. Hudson</i>	BB40. Large amplitude oscillatory shear of model synovial fluids. <i>Z. Zhang and G. F. Christopher</i>	SM40. The nonlinear rheology of multiscale complex fluids: Deriving empirical rules in rheology from fractional constitutive equations. <i>A. Jaishankar and G. H. McKinley</i>	NF25. Pair-particle trajectories in Bingham shear flow. <i>H. Fahs, G. Ovarlez and X. Chateau</i>	SG5. Various aspects of brittle and ductile behavior of different polymer glasses. <i>X. Li and S.-Q. Wang</i>	EF15. The surface tension of yield stress fluids. <i>P. Coussot and J. Boujlel</i>
3:35				COFFEE BREAK		
4:00	SC41. Modelling capillary break-up of particulate suspensions. <i>C. Mcllroy and O. G. Harlen</i>	BB41. Swimming dynamics of Escherichia coli in dilute polymer suspensions. <i>A. E. Koser and P. E. Arratia</i>	SM41. Model-based framework rheology. <i>R. L. Thompson, A. A. Alicke and P. R. de Souza Mendes</i>	NF26. Large amplitude oscillatory shear for a model of thixotropic yield stress fluids. <i>M. Renardy and T. Wang</i>	SG6. Rheology of glass-forming polymers at the nanometer size-scale: Films and surfaces. <i>G. B. McKenna, H. Yoon, A. K. Torres Arellano and M. Zhai</i>	EF16. Stability of monoclonal antibody solutions subject to expansion/compression cycles at the air/water interface. <i>G. L. Lin, J. A. Pathak and G. G. Fuller</i>
4:25	SC42. Colloidal aggregates formation and breakup under oscillatory flow. <i>M. Liard, D. Lootens, N. Martyss and P. Hebraud</i>	BB42. Chemical surfing of active particles and connection to chemotaxis of slime mold colonies. <i>H. Masoud, H. A. Stone and M. J. Shelley</i>	SM42. Chain relaxation of polystyrene-block-ethylene-co-butene-1-block-polystyrene copolymer after applying LAOS in the presence of modified graphene. <i>A. Faramarzi Jolfaei, J. Nasrollah Gavani, F. Goharpey and H. Nazockdast</i>	NF27. Non-Newtonian effects in a continuous squeeze flow film of a structured liquid. <i>E. E. Herrera-Valencia, M. L. Sanchez Villavicencio, R. Mendoza Serna, E. Vazquez Zamora and R. R. Mora Hernandez</i>	SG7. Effect of micro and nano particles on yielding, strain softening and strain hardening of PMMA. <i>J. Jancar and R. S. Hoy</i>	EF17. Adsorption/desorption kinetics versus interfacial rheology of lung surfactants replacements. <i>E. Hermans and J. Vermant</i>
4:50	SC43. Structural origins and nonlinear mechanics during yielding of a heterogeneous colloidal gel. <i>J. Kim, D. Merger, M. Wilhelm and M. Helgeson</i>	BB43. Swimming dynamics of microorganisms in viscoelastic fluids near a wall. <i>G. Li, A. Karimi and A. Ardekani</i>	SM43. Slip heating in die drool. <i>P. H. Gilbert and A. J. Giacomin</i>	NF28. Finite element modeling of blood flow in the branched brachial bifurcation using non-Newtonian parameters obtained from rheological measurements of normal blood samples of variable hematocrit levels. <i>R. D. Wilcox</i>	SG8. Stochastic constitutive model prediction of tertiary creep and recovery in glassy polymers. <i>G. Medvedev and J. Caruthers</i>	EF18. Polymer structure and rheology at fluid-fluid interfaces. <i>J. Samaniuk and J. Vermant</i>
5:15	SC44. Bond strength in colloidal depletion gels from direct measurement of thermal rupture force distributions. <i>K. A. Whitaker, L. C. Hsiao, M. J. Solomon and E. M. Furst</i>	BB44. Swimming and transport in a hexatic liquid crystal. <i>T. R. Powers, M. S. Krieger and S. E. Spagnolie</i>	SM44. Development of an algorithm determining continuous relaxation time spectrum. <i>J.-E. Bae and K. S. Cho</i>	NF29. Red blood cell aggregation investigation and characterization in a microfluidic device. <i>R. Mehri, C. Mavriplis and M. Fenech</i>	SG9. A molecular model for mechanics of polymer glasses. <i>S.-Q. Wang, S. Cheng, P. Lin and X. Li</i>	EF19. Microrheology studies of the mechanical evolution of interfacial protein layers and biofilms. <i>D. B. Allan, L. Vaccari, D. M. Firester, A. Singh, J. Sheng, D. H. Reich, K. J. Stebe and R. L. Leheny</i>
5:40	SC45. Micromechanics and non-linear rheology of reversible colloidal gels. <i>B. Landrum, W. B. Russel and R. Zia</i>	BB45. Undulatory swimming in shear-thinning fluids. <i>D. A. Gagnon, N. C. Keim and P. E. Arratia</i>	SM45. In-situ structural and thermo-rheological characterization of model thermoplastic polyurethane systems in shear and extensional flows. <i>J. Maia, R. Andrade, C. Ferreira and J. Gadley</i>	NF30. Design of an experimental setup for the study of the effect of swimming microbot's morphology on the complex fluid flows in microchannels. <i>S. Martinez-Aranda, F. J. Galindo-Rosales and L. Campo-Deaño</i>	SG10. Resolution of the local segmental mode in amorphous polymers: Do the chain relaxation modes affect the structural relaxation? <i>L. Grassia</i>	EF20. Interfacial rheology and dynamic mesostructure measurements of densely aggregated particle laden interfaces. <i>S. Barman and G. F. Christopher</i>
6:05				END		
6:05				POSTER SESSION & RECEPTION		Millennium Hall

Thursday, October 9

Morning

8:00	<i>Millennium Hall</i> Suspensions and Colloids	<i>Commonwealth B</i> Biomaterials and Biological Systems	<i>Commonwealth C</i> Polymer Solutions and Melts	<i>Commonwealth D</i> Self-assembly & Flow-induced Sys/Gels	<i>Commonwealth A1</i> Solids and Glasses	<i>Commonwealth A2</i> Emulsions, Foams & Interfacial
		AP1. Low-dimensional material functions for describing asymptotically-nonlinear viscoelasticity. <i>R. H. Ewoldt</i> (Metzner Award Presentation) Millennium Hall				
8:40	SC46. Manipulation of the mechanical properties of colloidal gels by steady and oscillatory shear. <i>G. Petekidis, E. Moghimi and N. Koumakis</i>	BB46. Swimming in circles: Using bacterial circulation as a non-contact microrheological probe. <i>A. A. Evans</i>	SM46. Mechanical characterization of thin polymer membranes at fuel cell operating conditions. <i>B. R. Caire, M. A. Vandiver, A. M. Herring and M. W. Liberatore</i>	SF21. The effect of branching on the nonlinear rheology of wormlike micelles (WLMs) using small angle neutron scattering (SANS) with spatial and temporal resolution. <i>M. A. Calabrese, S. A. Rogers and N. J. Wagner</i>	SG11. Accelerated assessment of the long-term performance of engineering polymers. <i>M. Kanfers and L. Govaert</i>	EF21. Buckling of particle-laden interfaces. <i>T. Kassuga and J. Rothstein</i>
9:05	SC47. Study of the rheology and wall slip of carbon black suspensions for semi-solid flow batteries. <i>A. Helal, K. Smith, F. Fan, X. W. Chen, J. M. Nóbrega, Y.-M. Chiang and G. H. McKinley</i>	BB47. Dynamics of active suspensions in confinement: Kinetic theory and numerical simulations. <i>B. Ezhilan and D. Saintillan</i>	SM47. Effect of hydration on mechanical properties of anion exchange membranes. <i>M. A. Vandiver, B. R. Caire, Y. Li, D. M. Knauss, A. M. Herring and M. W. Liberatore</i>	SF22. Microstructure, temperature, aging and rheological studies of an ionic micellar structure composed by a p-p organic salt. <i>J. J. Cardiel, Y. Zhao, P. De la Iglesia, L. D. Pozzo and A. Q. Shen</i>	SG12. Aging of polymeric films used in protective glazing systems. <i>C. White, K. T. Tan and D. Hunston</i>	EF22. Generation of stable non-spherical capsules with controlled interfacial coverage of surface-active particles. <i>A. P. Kotula and S. L. Anna</i>
9:30	SC48. Shear-enhanced aggregation of uniform and Janus spheres in the dilute-sphere limit: A Brownian dynamics simulation approach. <i>M. Mohammadi, J. Liu, E. D. Larson and R. G. Larson</i>	BB48. Theory of locomotion in complex fluids. <i>G. Elfring and E. Lauga</i>	SM48. Polymer degradation in drag-reducing flows in pipes at fixed inlet pressure. <i>E. J. Soares, L. Silveira, G. A. Barrientos, F. Thomaz, R. T. Silva and A. S. Pereira</i>	SF23. Linear and nonlinear rheology of wormlike micelles with cationic surfactant and organic hydrotropic salt mixture. <i>Y. Zhao and A. Q. Shen</i>	SG13. Linear viscoelasticity of soft glassy materials. <i>M. Kaushal and Y. M. Joshi</i>	EF23. Measuring moduli of elastic biofilms at oil-water interfaces by pendant drop method. <i>L. Vaccari, D. B. Allan, N. Sharifi-Mood, J. Sheng, R. L. Leheny and K. J. Stebe</i>
9:55	COFFEE BREAK					
10:25	SC49. Nanodiamond gels: Colloidal and rheological properties. <i>N. A. Burns, S. R. Raghavan, A. Shojaei and S. A. Khan</i>	BB49. Emulsion-templated nanocomposite gel microparticles for lung imaging and drug delivery. <i>B. R. Benson, N. M. Pinkerton, B. K. Wilson, D. Adler, D. Gao, S. Mettu, R. Dagastine, P. J. Sinko, H. A. Stone and R. K. Prud'homme</i>	SM49. Rheology of enhanced oil recovery polymers for high-temperature and high-salinity reservoirs. <i>S. M. R. Quadri, M. R. Hashmet and A. A. Abdala</i>	SF24. The sequencing of dynamic rheological measurements. <i>S. A. Rogers, M. A. Calabrese and N. J. Wagner</i>	SG14. Particle rearrangements and rheology in a 2D glassy solid near yielding. <i>N. C. Keim and P. E. Arratia</i>	EF24. Interfacial rheology and microstructure of carbon nanotubes at an air-water interface. <i>S. Vora, B. Bognet, H. Patanwala, F. Chinesta and A. K. Ma</i>
10:50	SC50. Numerical computation of permeability in unstable colloidal gels. <i>A. M. Mertz, M. S. Ingber, A. Graham, A. Redondo and L. Gelb</i>		SM50. Effect of viscoelastic properties of polymer solutions on Stribeck scaling. <i>E. Pashkovski and R. Patterson</i>	SF25. A suggestive rheological behaviour of branched micellar solutions. <i>D. Gaudino, N. Grizzuti and R. Pasquino</i>	SG15. Evidence for deformation dependence of heat capacity in cross-linked natural rubber. <i>D. Nieto Simavilla, D. C. Venerus and J. D. Schieber</i>	EF25. Flow behavior of Janus monolayers. <i>S. Razavi, S. R. Bhatia and I. Kretzschmar</i>
11:15				SF26. Light-activated fluidic valve by triggering the ionic gelation of a biopolymer. <i>H. Oh, V. Javvaji, A. X. Lu, R. Hashemipour and S. R. Raghavan</i>	SG16. Direct observation of the end-to-end distance between crosslinks for silica-based model-rubber networks with mono-disperse short chains. <i>T. A. Tervoort, C. Clarijs and W. R. Caseri</i>	EF26. Co-continuous polymer blends with silica nanoparticles stabilized at interface. <i>L. Bai, C. W. Macosko and X. Cheng</i>
11:40				SF27. Migration and alignment of anisotropic planar particles with pinned contact lines at a curved interface. <i>N. Sharifi-Mood, L. Yao, I. B. Liu and K. J. Stebe</i>	SG17. Non-Newtonian behavior of nuclear glass melts containing insoluble PGE particles. <i>J. Puig, M. Neyret and P. Marchal</i>	EF27. PIV measurement of transient fluid flow due to the adsorption of particles. <i>N. A. Musunuri, P. Singh and I. S. Fischer</i>
12:05				END		

Poster Session

Wednesday 6:05 PM – 8:00 PM Millennium Hall

- PO1.** The non-monotonic torque response of a model cellulosic biomass slurry during settling and resuspension. *N. C. Crawford, M. A. Sprague and J. J. Stickel*
- PO2.** An investigation on rheological behaviour of thermally-treated digested sludge: Dependency on solid concentration. *E. Farno*
- PO3.** Phase behavior of dilute carbon black suspensions and carbon black stabilized emulsions. *M. P. Godfrin, A. Tiwari, A. Bose and A. Tripathi*
- PO4.** Damping of sloshing of a liquid bath using a thin foam layer. *F. Boulogne, A. Sauret, J. Cappello and H. A. Stone*
- PO5.** Electric field induced self-assembly of monolayers of sub-micron sized particles on flexible thin films. *K. Shah, M. S. Hossain, E. C. Amah, I. S. Fischer and P. Singh*
- PO6.** Food emulsions, interfacial properties measured with the Double Wall Ring geometry. *C. A. Gracia-Fernández, A. Elmoumni, A. Pérez-Quintáns and J. Méndez-Dónega*
- PO7.** Rheological characterization of a UV curing optical adhesive. *C. A. Gracia-Fernández and A. Elmoumni*
- PO8.** The effects of emulsifying additives on the interface of oil and water. *S. Cotts*
- PO9.** Effect of material rheology on polymer blend thin film morphology. *J. A. Emerson, E. M. Furst and T. H. Epps, III*
- PO10.** Investigation of rheological properties of emulsified asphalts to evaluate viscoelastic behaviors. *A. Golalipour and D. Salomon*
- PO11.** Validation of effective time translational invariance for polymer undergoing crosslinking reaction. *M. Kaushal and Y. M. Joshi*
- PO12.** Standard and developmental methods for performing rubber rheometry. *G. W. Kamykowski and T. R. Rauschman*
- PO13.** Shear rheology of imidazolium-based ionic liquids with aromatic functionality. *R. Tao and S. L. Simon*
- PO14.** Investigation of thermal transport in polymers using infrared thermography. *D. Nieto Simavilla, D. C. Venerus and J. D. Schieber*
- PO15.** Polylactic acid nanocomposites with improved toughness. *E. Acik, N. Orbey and U. Yilmazer*
- PO16.** Viscoelastic behavior of zinc sulfonated EPDM- zinc stearate (ZnSt) shape memory polymers. *C. Huang and R. A. Weiss*
- PO17.** Linear viscoelasticity and dielectric spectroscopy of ionomer/plasticizer mixtures: A transition from ionomer to polyelectrolyte. *N. Bao, Q. Chen, J. H. Wang, T. Tunic, S. Liang and R. H. Colby*
- PO18.** Optical observations and Raman spectroscopy during flow-induced crystallization of polyethylene. *A. P. Kotula, A. Hight Walker and K. B. Migler*
- PO19.** Modelling of synthesis and flow properties of propylene-diene copolymers. *C. Das, D. J. Read, J. M. Soulages and P. P. Shirodkar*
- PO20.** Mechanically robust anion exchange membranes at variable hydrations. *M. A. Vandiver, B. R. Caire, Y. Li, D. M. Knauss, A. M. Herring and M. W. Liberatore*
- PO21.** Rheological evaluation of hydroxypropyl methylcellulose (HPMC) as a gluten replacer during a simulated baking process. *M. E. Hines and T. T. Chen*
- PO22.** Degradation of covalently adaptable hydrogels manipulating their chemical equilibrium. *F. S. Escobar IV, M. D. Daniel, K. S. Anseth and K. M. Schultz*
- PO23.** Effects of association strength of noncovalent bonding on viscoelasticities of supramolecular polymer gels. *S. Matsushima, M. Hayashi, H. Yamagishi, A. Noro and Y. Matsushita*
- PO24.** Rheology and end-use properties of acrylic polymers for high performance elastomeric sealants. *C. L. Jackson, J. Ngunjiri, P. K. Jog, A. Liss, J. R. Lowe, M. Westmeyer, J. Rubini and M. McGinnis*
- PO25.** Rheology and microstructure of phase separating blends filled with graphene and carbon black. *M. Z. Iqbal, A. A. Abdala and M. W. Liberatore*
- PO26.** Decomposing tensile stress during startup uniaxial extension of entangled melts. *P. Lin and S.-Q. Wang*
- PO27.** Thermal signature of a shear crystallized semiconducting polymer solution. *R. Remy, N. A. Nguyen and M. E. Mackay*
- PO28.** Stress relaxation behavior of polymer glasses in extension and compression. *J. Liu, P. Lin and S.-Q. Wang*
- PO29.** Thermal-stiffening of dynamically asymmetric interfaces in polymer nanocomposites. *E. Senses and P. Akcora*
- PO30.** Mechanical and morphological characterization of thin polymer membranes under environmental control. *B. R. Caire, M. A. Vandiver, A. M. Herring and M. W. Liberatore*
- PO31.** Design of yield-stress fluids: A rheology-to-structure inverse problem. *A. Z. Nelson and R. H. Ewoldt*
- PO32.** Carboxymethyl hydroxyethyl cellulose (CMHEC) as a gelling agent in hydraulic fracturing application. *F. Song, T. T. Chen, M. Melbouci, J. Wang and B. Gonska*
- PO33.** Rheological characterization of end-clathrated polymers. *O. Urakawa, M. Mizohata and T. Inoue*
- PO34.** Detailed analysis of linear viscoelastic behavior of poly(ionic liquids) with rheo-optical methods. *A. Matsumoto and T. Inoue*
- PO35.** Importance of humidity control in the rheological characterization of foods. *J. P. Eickhoff, R. Roohnia and G. Arnold*
- PO36.** Rheological characterization of dough in shear and extension. *M. Meerts, R. Cardinaels, F. Oosterlinck, C. Courtin and P. Moldenaers*
- PO37.** Flow behavior of carrot suspensions as a dispersed system. *N. Younessinaki and M. G. Scanlon*
- PO38.** Influence of process temperature, nanoclay and glycerol content on rheological behavior of taro (*Colocasia esculenta* (L.) Schott) flour film-forming solutions. *A. V. Ramos, V. M. Calado and C. P. Carvalho*
- PO39.** Thermogelation and rheological behavior of aqueous nano fibrillated cellulose suspensions. *N. Quennouz and C. Osuji*
- PO40.** Chemorheology of thermal-UV dual curable organic coatings: Role of thermal radical initiator on properties of automotive clearcoats in the dual curing process. *J. W. Hwang, K. N. Kim, S. M. Noh and H. W. Jung*
- PO41.** Chemorheology of glycidyl azide polymer (GAP) - bi-propargyl succinate reactive system. *C. Dubois and E. Comtois*
- PO42.** Impact of rheology on static friction. *F. Wolf*
- PO43.** Rheology of soft colloids across the onset of rigidity: Scaling behavior, thermal, and non-thermal responses. *Y. Xu*

- PO44.** The effect of curcuminoids on gelation behavior of concentrated solution of methylcellulose. *L. Rakesh, I. Lysenko, J. Zhao, N. Almeida and A. Mueller*
- PO45.** An evaluation of hysteresis in the viscosity of aluminum oxide colloidal suspension in water observed during measurements. *M. T. Sharif and C. C. Tang*
- PO46.** Yield stress measurements on concrete and cement pastes. *J. Plog, F. De Vito and J. Nijman*
- PO47.** Variation in concentration of non-Newtonian fluid suspensions at bifurcations. *J. Maxey, J. F. Morris and P. Nguyen*
- PO48.** Rheological behavior of wall-slip dominant polybutadiene solutions. *M. Wang and S.-Q. Wang*
- PO49.** Rheology testing method development on gypsum material. *X. Chen*
- PO50.** Stress-input rheology for design intuition and user experience. *R. E. Corman, J. Godman and R. H. Ewoldt*
- PO51.** Analysis of cocoa content in chocolate using tribo-rheometry and its correlation to mouthfeel. *A. K. Latshaw*
- PO52.** Tribo-rheology of personal care products: Correlation to sensory evaluation. *K. Penfield*
- PO53.** Accurate measurement of low viscoelasticity near gelation point by electromagnetically spinning system. *T. Hirano and K. Sakai*
- PO54.** Mechano-electric transduction performance of actuation device based on liquid crystals membrane flexoelectricity. *E. E. Herrera-Valencia and A. D. Rey*
- PO55.** Adding an additional dimension to the measurement of viscosity: Using a biaxial confocal-rheoscope to study squishy materials. *N. Lin, J. H. McCoy, X. Cheng, B. D. Leahy, J. Israelachvili and I. Cohen*
- PO56.** Development of a vibrating wire rheometer. *C. Hopkins and J. de Bruyn*
- PO57.** Near-wall nanovelocimetry based on Total Internal Reflection Fluorescence with continuous tracking. *L. D'Eramo*
- PO58.** Morphology and flow behavior of multilamellar vesicles in surfactant solutions. *A. Pommella, D. Donnarumma, A. Perazzo, S. Caserta and S. Guido*
- PO59.** Using the immobilization cell for characterization of paint upon drying. *N. Hesse and B. Rajaram*
- PO60.** Shear thinning behavior of metal melts. *R. Elke, P. Kamerkar, P. Brandes and D. Schütz*
- PO61.** Developments in touch-screen, rotational, rheometry systems. *D. J. Moonay*
- PO62.** Effect of sloped die lip design on operability window and frequency response in slot coating process using viscocapillary model. *W.-G. Ahn, S. H. Lee, H. S. Ji, J. Nam and H. W. Jung*
- PO63.** Applications of electromagnetically spinning sphere viscometer. *M. Yasuda, T. Hirano and K. Sakai*
- PO64.** Oscillatory rheology at fluid-fluid interfaces: Uncoupling material and system responses. *J. Samaniuk and J. Vermant*
- PO65.** A new innovative method to improve process control of processed cheese via in-line viscosity measurement. *O. Reglat*
- PO66.** Improvements in rheomicroscopy due to stagnation plane created by counter-rotation. *T. Perera and G. Paroline*
- PO67.** Orthogonal superposition measurements on thermo reversible gels. *M. Namani*
- PO68.** Microfluidics: A rheo-optical tool to study micro-structured emulsions and their flow instabilities. *V. Preziosi, A. Perazzo, R. D'Apolito, G. Tomaiuolo, S. Caserta and S. Guido*
- PO69.** Rheo-optical characterization of colloidal suspensions using a novel optical device. *B. Rajaram and A. Elmoumni*
- PO70.** Polymer relaxation and stretching dynamics in semi-dilute DNA solutions: A single molecule study. *K.-W. Hsiao, C. A. Brockman and C. M. Schroeder*
- PO71.** Active fractal gels of colloidal Janus spheres. *M. E. Szakasits and M. J. Solomon*
- PO72.** Microrheological investigation of a biofilm and its constituent extracellular polymers. *M. Ganesan, J. G. Younger and M. J. Solomon*
- PO73.** Microrheology of a colloidal gel in a water-surfactant solution. *M. D. Wehrman, S. Lindberg and K. M. Schultz*
- PO74.** Relaxation of particle motion in bimodal suspensions during drying via multi-speckle diffusing wave spectroscopy. *G. J. Oh, J. W. Hwang, S. J. Lee and H. W. Jung*
- PO75.** Generalized work relations for polymer solution rheology. *F. Latinwo, P. Corona, J. Moller and C. M. Schroeder*
- PO76.** Diffusing wave spectroscopy: A modern light scattering technique to characterize the rheological properties of soft matter systems. *F. Mondiot, M. Reufer and A. C. Voelker*
- PO77.** Monitoring phases and phase transitions in two phosphatidylethanolamine monolayers using active interfacial microrheology. *S. Ghazvini and P. Dhar*
- PO78.** Active microrheology studies of colloidal suspensions. *S. Hurtado Parra, R. T. Stull, X. Du, E. R. Weeks, R. Zia and P. Habdas*
- PO79.** Experiments to interrogate polyurethane foam bubble growth. *C. O. Brady, G. Soehnel, M. M. Soehnel, B. Shelden, C. C. Roberts and L. A. Mondy*
- PO80.** Inferring molecular information by determination of the fitting parameters to nonlinear oscillatory shear data. *P. K. Singh and R. H. Ewoldt*
- PO81.** Small and large amplitude oscillatory shear analysis of ballistic witness materials. *J. E. Seppala, Y. Heo and G. A. Holmes*
- PO82.** Investigating rheological properties of wheat flour dough at different stages of farinogram using LAOS. *G. Yazar, O. C. Duvarci, S. Tavman and J. L. Kokini*
- PO83.** Comparison of the LAOS characteristics of four structured foods consisting of a concentrated emulsion (mayonnaise), a concentrated suspension (tomato paste) and a viscoelastic network (hard and soft dough) products using LAOS. *O. C. Duvarci, G. Yazar and J. L. Kokini*
- PO84.** Comparison of conventional rheology and FT rheology analysis for commercial toothpaste formulations. *S. Ozkan, W. E. Prosise, F. Chen and G. Puccetti*
- PO85.** Spray droplet size predictions using microfluidic extensional rheometry. *S. Ozkan, S. Kamin and S. Sarkar*
- PO86.** Suspensions of solid particles at thermoclines. *A. Doostmohammadi and A. Ardekani*
- PO87.** Modeling interactions in carbon nanotube suspensions: Transient flows. *G. Natale, J. Ferec, G. Ausias, M.-C. Heuzey and P. J. Carreau*
- PO88.** Nanoparticle dispersion in a polymer matrix: Scientific problem and technological opportunity. *J. Jancar*
- PO89.** Pair-particle trajectories in Bingham shear flow. *H. Fahs, G. Ovarlez and X. Chateau*
- PO91.** Rapid colloidal self-assembly through periodic variation of inter-particle potentials. *S. R. Risbud and J. W. Swan*

- PO92.** Model for the shear viscosity of solutions of star polymers and other soft particles. *C. I. Mendoza*
- PO93.** Jammed soft-particle suspensions: Spatial correlations, rheology and diffusion. *A. P. Roy and C. Maloney*
- PO94.** Secondary-flow behavior of non-Newtonian fluids with Carreau-Yasuda model in curved rectangular microchannels. *K. Yoon, H. W. Jung and M.-S. Chun*
- PO95.** Molecular scale simulation of shear, parabolic, and extensional flow: Implementation and findings. *N. A. Rorrer and J. R. Dorgan*
- PO96.** Dynamics of deformable and orientable objects in electric field and fluid flow gradients. *H. Pandey and P. T. Underhill*
- PO97.** Numerical study of the three-dimensional effects of drop deformation as consequence to an imposed two-dimensional elongational flow with vorticity. *A. Sanjuan, M. A. Reyes, A. Minzoni and E. Gefroy*
- PO98.** Active probe rheology of polymer melts from molecular simulations: Investigation of the non-linear regime. *M. Karim and R. Khare*
- PO99.** Mesodynamic simulation of drug molecule distribution in lipids surfactants. *L. Rakesh*
- PO100.** Rheology of dispersions in the ionic liquid [Bmim][BF₄]. *J. Gao, M. B. Shiflett and N. J. Wagner*
- PO101.** Long-time transient responses of branched wormlike micelles under nonlinear shear flows. *M. A. Calabrese, S. A. Rogers and N. J. Wagner*
- PO102.** Rheological behavior of silica nanoparticles measured by small angle x-ray scattering. *J. Lee, S. Narayanan, X.-M. Lin and A. R. Sandy*
- PO103.** Rheology of sulfonated polystyrene ionomers. *S. Vorontsov, A. I. Leonov and R. A. Weiss*
- PO104.** Identifying the mechanisms of shear-induced clustering in polymer-colloid mixtures using 3D rheo-SANS measurements. *J. Kim and M. Helgeson*
- PO105.** Extensional FlowSANS at the NIST Center for Neutron Science. *K. M. Weigandt*
- PO106.** Gelation of patchy rods. *N. Kazem and C. Maloney*
- PO107.** Origin of shear thickening in semidilute wormlike micellar solutions. *J. Pérez-González, B. M. Marín-Santibáñez and F. Rodríguez-González*
- PO108.** Effect of curvature on shear banding of wormlike micelles in Taylor-Couette flow. *P. Cheng, G. Leal and M. Helgeson*
- PO109.** Multiphase waxy crude oils rheo-optical characterization. *S. Caserta, A. Perazzo and S. Guido*
- PO110.** Effect of droplet stiffness on the dynamics of dense emulsions. *X. Di, Z. Shao and C. Osuji*
- PO111.** Transient yield in reversible colloidal gels: A micro-mechanical perspective. *B. Landrum, L. C. Johnson, W. B. Russel and R. Zia*
- PO112.** Manipulating particle shapes: Deformation and solidification of molten wax drops at an immiscible liquid interface. *S. N. Beesabathuni, S. Lindberg, C. Wesner, M. Caggioni and A. Q. Shen*
- PO113.** Microfluidics based conducting polymer polyaniline particles for glucose sensing. *S. N. Beesabathuni, J.-H. Chung and A. Q. Shen*
- PO114.** Analysis of flow-induced structure in CTAB/NaSal aqueous solution using polarization imaging. *N. Oba and T. Inoue*
- PO115.** Micro-mechanics and nonlinear rheology of reversible colloidal gels: Creep and delayed yield. *B. Landrum, W. B. Russel and R. Zia*
- PO116.** Shear thickening fluid (STF) – nanocomposites for improved hypervelocity impact protection against micrometeoroids and orbital debris. *C. D. Cwalina, R. D. Dombrowski and N. J. Wagner*
- PO117.** Non-equilibrium depletion interactions in colloidal dispersions. *B. E. Dolata and R. Zia*
- PO118.** Diffusion and rheology in a suspension of hydrodynamically interacting colloids enclosed by a spherical cavity. *C. Aponte-Rivera and R. Zia*
- PO119.** Structure and rheology of binary Pluronic block copolymer mixtures in the protic ionic liquid ethylammonium nitrate. *R. Chen, C. R. López-Barrón and N. J. Wagner*
- PO120.** X-ray photon correlation spectroscopy studies of structural irreversibility in a colloidal gel subjected to oscillatory shear flow. *M. S. Kweon and W. Burghardt*
- PO121.** The use of the mathematical model of Volterra in the aggregation of deoxy-hemoglobin S molecules in sickle cell anemia. *F. E. Mensah*
- PO122.** Wave propagation and blood rheology. *N. H. Le, F. E. Mensah and H. T. Teju*
- PO123.** Development of a viscosity-pressure drop correlation model for predicting physical behavior in medical tubing. *Y. Sun, E. J. Correa and E. M. McCready*
- PO124.** Bacterial biofilms can increase their stiffness by making more of a soft biopolymer. *V. D. Gordon, K. Kovach and M. Davis-Fields*
- PO125.** Numerical and experimental modeling of blood sedimentation. *E. Niazi and M. Fenech*
- PO126.** Random walk simulation and one-particle tracking of fibroblast cells. *C. M. V. Galon and R. Bacabac*
- PO127.** A visual scripting interface for human red blood cells' osmotic characteristics. *C. M. V. Galon and R. Bacabac*
- PO128.** Numerical study of the influence of the swimming microbot's morphology in a blood analogue fluid flow. *S. Martinez-Aranda, F. J. Galindo-Rosales and L. Campo-Deaño*
- PO129.** Numerical study of the flow of a shear thickening fluid expelled out from a cell. *S. Martinez-Aranda, L. Campo-Deaño and F. J. Galindo-Rosales*
- PO130.** Velocity profile measurements of blood in PDMS bifurcating microchannels using micro-particle image velocimetry. *O. R. Glich and M. Fenech*
- PO131.** Correlating protein-protein interactions and solution viscosities at high concentration. *M. A. Woldeyes, E. M. Furst and C. J. Roberts*
- PO132.** A novel method to characterize the creep recovery of soft biomaterials. *N. M. Eren, F. Breidi and O. H. Campanella*
- PO133.** Slip and flow dynamics of thin polymer films. *S. M. Sabzevari, J. McGraw, K. Jacobs and P. M. Wood-Adams*

Loews Philadelphia Hotel Meeting Space

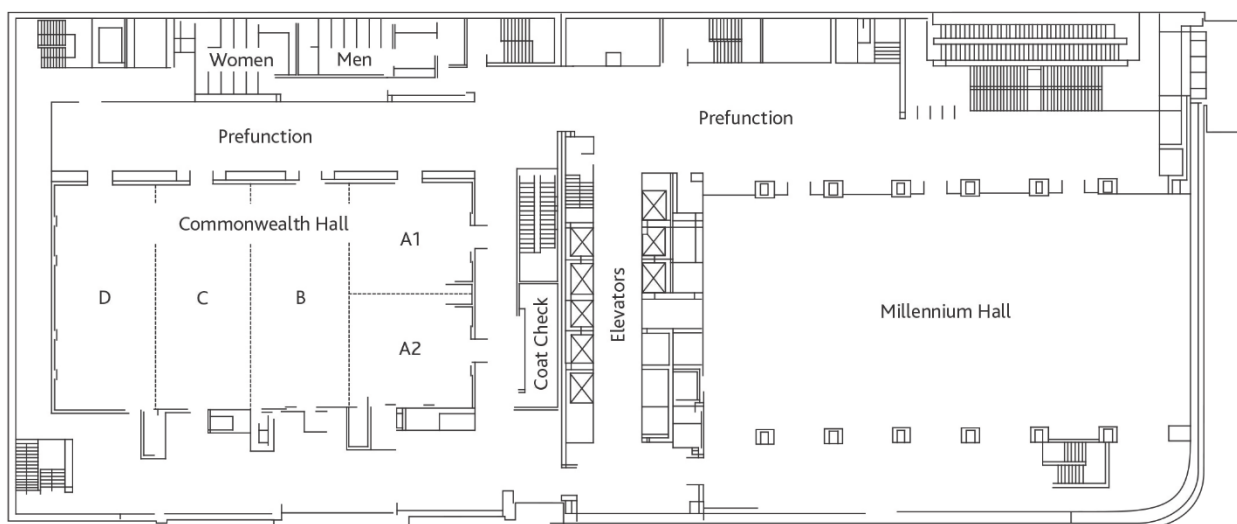

Second Floor

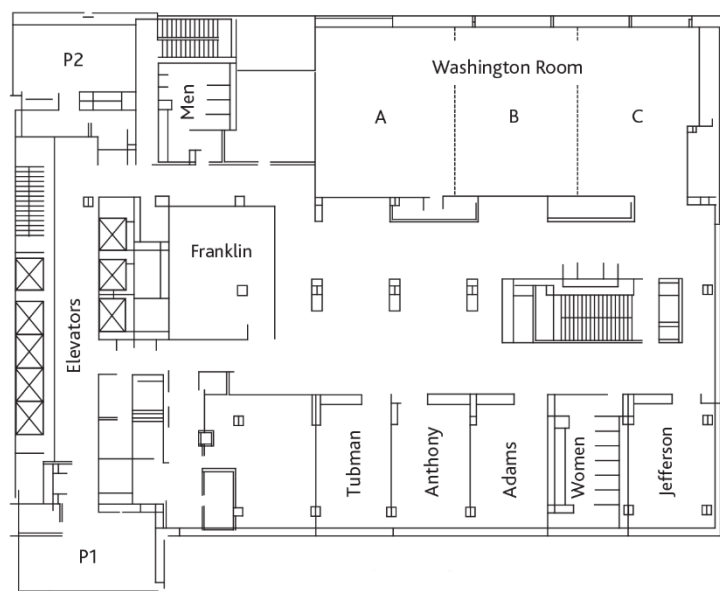

Third Floor

Social Program

Sunday, October 5

Industry/Faculty/Student Forum: *Rheology in the Real World*

4:00 PM – 6:00 PM Washington C

Sponsored by AIP and The Dow Chemical Company

Welcoming Reception

6:30 PM – 8:30 PM 33rd Floor of Loews Philadelphia Hotel

Hosted by TA Instruments

Tuesday, October 7

Rocky Rheology Run

6:45 AM Loews Philadelphia Hotel Lobby

Society Business Meeting

12:05 PM 1:30 PM Commonwealth D

Awards Reception

7:00 PM – 8:00 PM Millennium Prefunction Area

Sponsored by Xpansion Instruments

Awards Banquet

8:00 PM Millennium Hall

Wednesday, October 8

Poster Session Reception

6:05 PM – 8:00 PM Millennium Hall

Sponsored by Anton-Paar USA

*The Society gratefully acknowledges the generous support of
Anton-Paar USA, Malvern Instruments, TA Instruments, Xpansion Instruments
American Institute of Physics, The Dow Chemical Company
Department of Chemical and Biomolecular Engineering and
Center of Molecular Engineering and Thermodynamics at University of Delaware.*